

scrjhu-000395-1-CE-044.4P-N-O

REV	CHANGE DESCRIPTION	ECN	DATO	OPPDATERT AV	APPROVED BY
-----	--------------------	-----	------	--------------	-------------

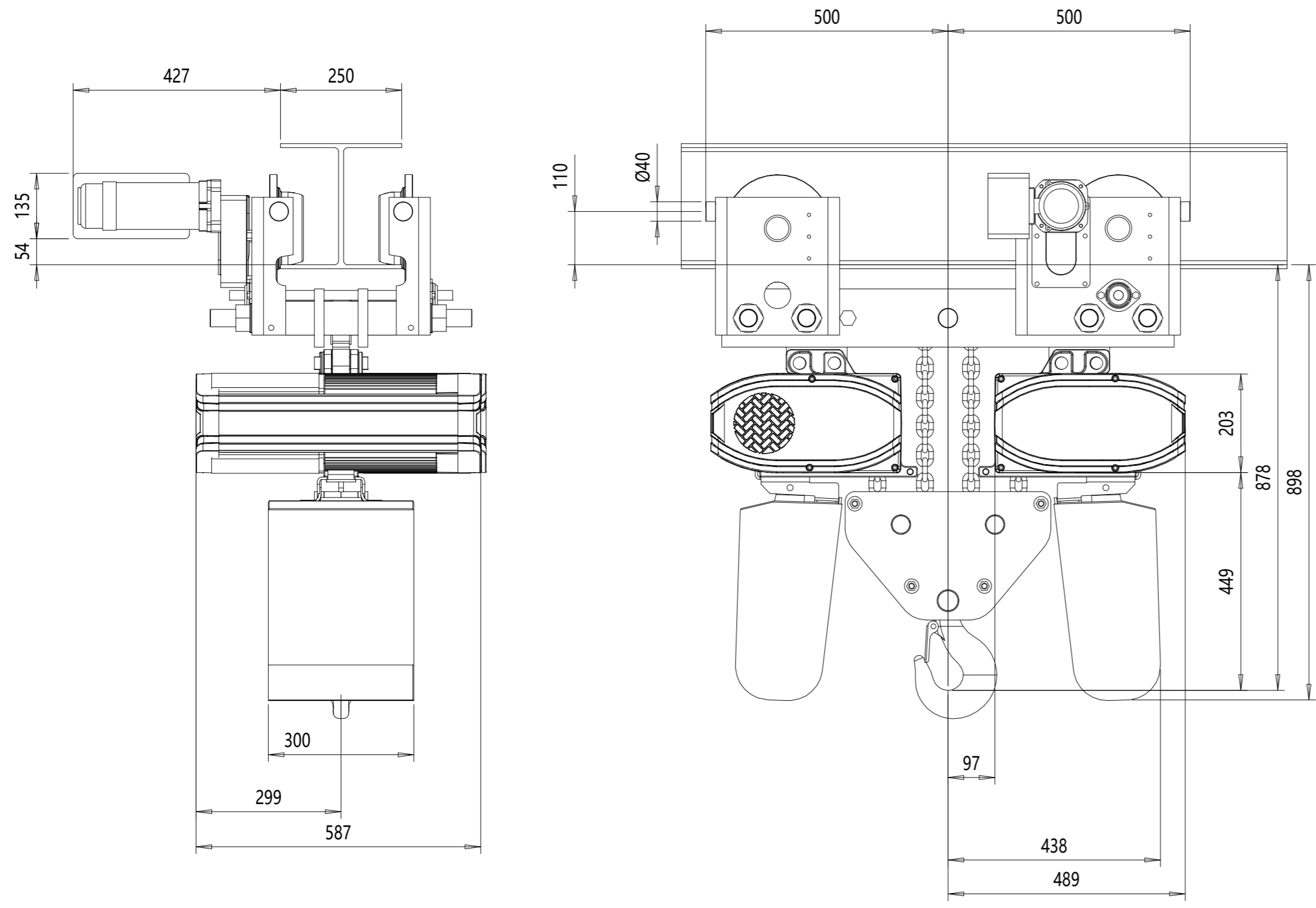

TEKNISKE DATA

Talje	: CE-044.4P-N
Last	: 10000 kg
Løftehøyde	: 5 m
Heisehastighet	: 4 / 0.7 m/min
Katthastighet	: Inverter 2 Steps:17/3.8 m/min
Vekt av katt	: 442 kg
Krangruppe, heis	: M4
Strømtilførsel	: 230 / 48 V; 50 Hz

Pos	Amount	Beskrivelse	Spesifikasjon		
		scrjhu/Norway	Kont	Godkjent	DAS / M@ngo
		Konstruksjon			Vx proj
		Dato	2023.03.08		
		Avd	ELEKTRISK KJETTINGTALJE		
			-		
			-		
			scrjhu-000395-1-CE-044.4P-N-O		

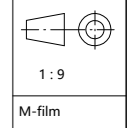

SWF Krantechnik reserves the right to alter or amend the above information without notice. This document and the information contained herein, is the exclusive property of SWF Krantechnik and represents a non-public, confidential and proprietary trade secret that may not be reproduced, disclosed to third parties, altered or otherwise employed in any manner whatsoever without the express written consent of SWF Krantechnik GmbH. Copyright © SWF Krantechnik. All rights reserved.

scrjhu-000395-1-CE-044.4P-N-OI

REV	CHANGE DESCRIPTION	ECN	DATO	OPPDATERT AV	APPROVED BY
-----	--------------------	-----	------	--------------	-------------

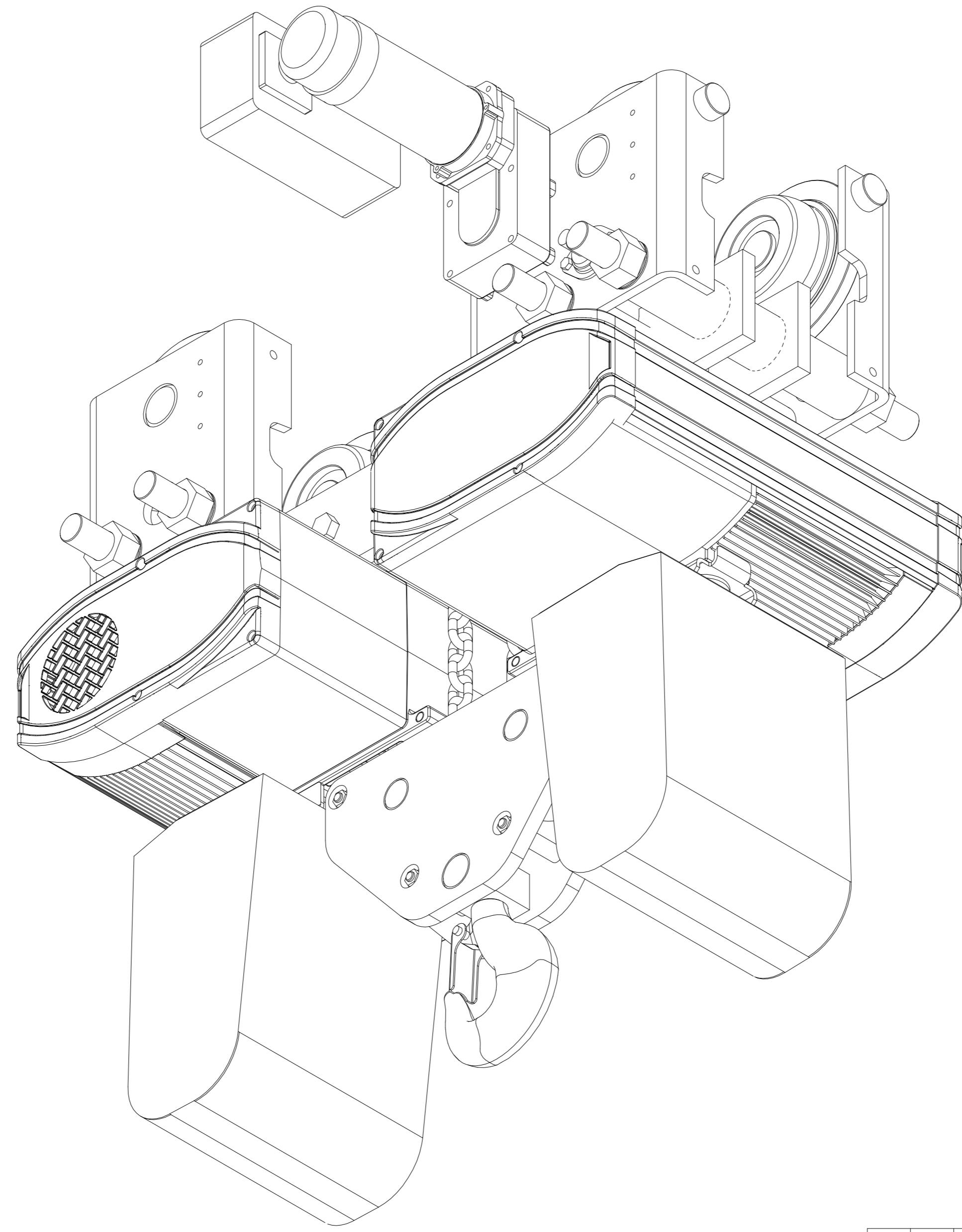

Pos	Amount	Beskrivelse	Spesifikasjon		
		scrjhu/Norway	Kont	Godkjent	DAS / M@ngo
		Konstruksjon			Vx proj
		2023.03.08	ELEKTRISK KJETTINGTALJE		
		Dato			
		-			
		Avd			
		-			
		SWF KRANTECHNIK™			
		scrjhu-000395-1-CE-044.4P-N-OI			
			1:2.5		
			M-film		
			Issue		

SWF Krantechnik reserves the right to alter or amend the above information without notice.
 This document and the information contained herein, is the exclusive property of SWF Krantechnik, and represents a non-public, confidential and proprietary information. No part of this document may be reproduced, stored in a retrieval system, or transmitted in any form or by any means, electronic, mechanical, photocopying, recording, or by any information storage and retrieval system, without the express written consent of SWF Krantechnik GmbH. Copyright © SWF Krantechnik. All rights reserved.

Dobbel kopi